

# QA4205 Mulcher Operators Manual

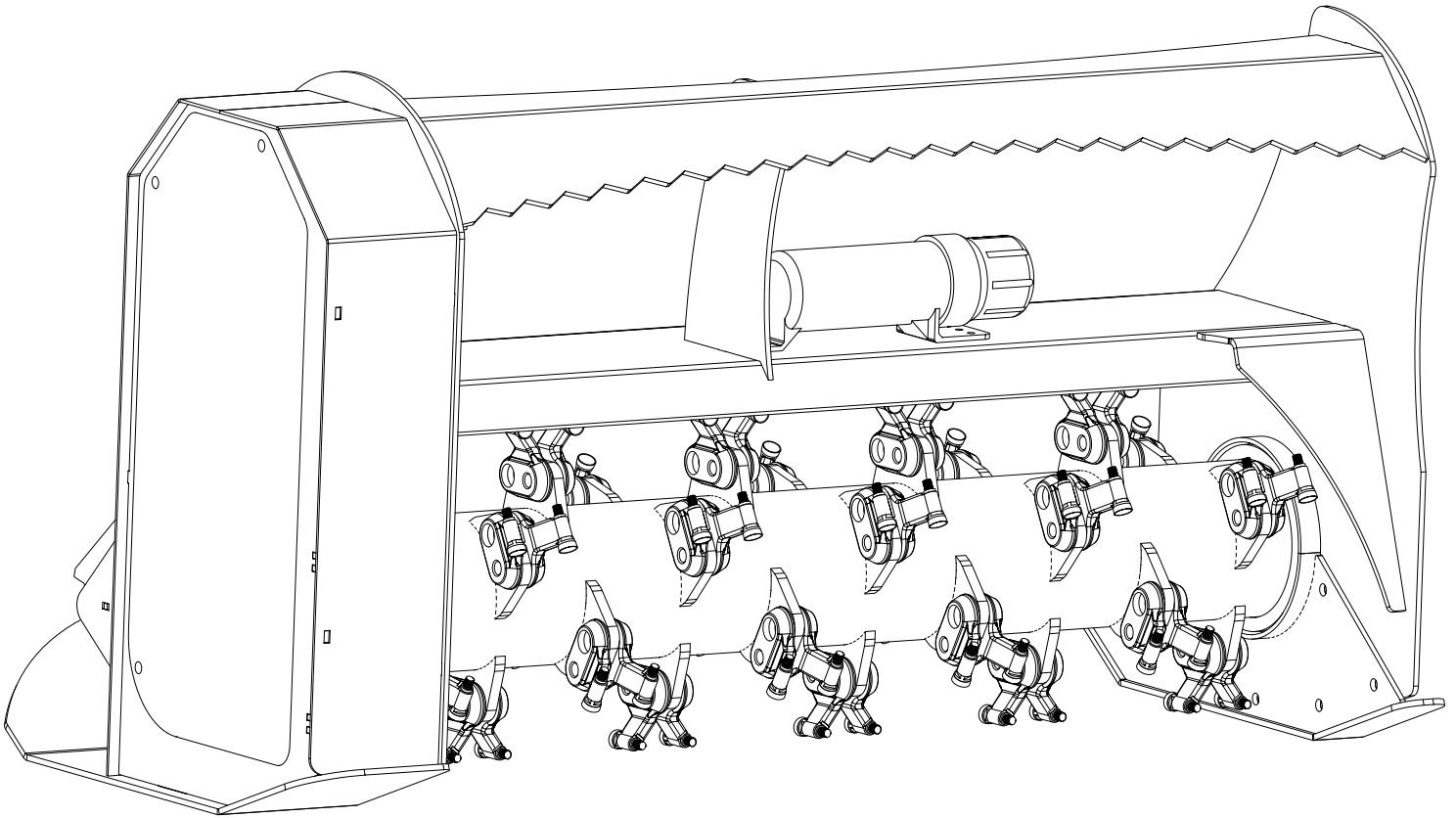

**Skid Pro Attachments**  
**PO Box 982**  
**Alexandria, MN 56308**  
**[www.skidpro.com](http://www.skidpro.com)**

**October 2021**

# CONTENTS

<b>1. INTRODUCTION</b>	<b>1</b>
1.1 OVERVIEW	1
1.2 INTENDED USE AND FORESEEABLE MISUSE	1
<b>2. SAFETY</b>	<b>2</b>
2.1 SAFETY ALERT SYMBOL AND SAFETY WORDS	2
2.2 OPERATIONAL HAZARDS	2
2.2.1 PREPARE FOR EMERGENCIES	3
2.2.2 REPLACE SAFETY SIGNS	3
2.2.3 Do NOT ALLOW RIDERS	3
2.2.4 LOWER OPERATING SPEED	3
2.2.5 AVOID ROLLOVER	3
2.2.6 AVOID POWERLINES & UNDERGROUND UTILITIES	4
2.2.7 DETACH BRUSH MULCHER SAFELY	4
2.2.8 RAISED ATTACHMENT	4
2.2.9 AVOID LOUD NOISE	4
2.2.10 HAZARDS FROM MODIFYING EQUIPMENT	4
2.2.11 AVOID WOOD DUST INHALATION	4
2.2.12 AVOID HIGH PRESSURE FLUIDS	4
2.3 MAINTENANCE HAZARDS	6
2.4 SAFETY SIGNS	8
<b>3. INITIAL SETUP</b>	<b>10</b>
3.1 HYDRAULICS	10
<b>4. OPERATION</b>	<b>11</b>
4.1 PREPARATION FOR USE	11
4.2 PRE-OPERATION CHECK LIST	11
4.3 MACHINE COMPONENTS	12
4.4 ATTACH TO SKID STEER	12
4.5 DETACH FROM SKID STEER	13
4.6 TRANSPORTING	13
4.7 CARBIDE TEETH BREAK-IN	13
4.8 FIRST TIME USER TIPS	14
4.9 FIELD OPERATION	15
4.10 CLEARING JAMS	16
<b>5. ROUTINE MAINTENANCE</b>	<b>17</b>
5.1 MAINTENANCE	17
5.2 INSPECTIONS	17
5.3 CHECK BELT TENSION	18
5.4 REPLACE BELT	19
5.5 ROTATE CUTTING TEETH	20
5.6 REPLACE CUTTING TEETH	20
5.7 REPLACE TOOTH HOLDER	21
5.8 LUBRICATE ROTOR BEARINGS	22
<b>6. TROUBLESHOOTING</b>	<b>23</b>
<b>7. STORAGE</b>	<b>24</b>
7.1 STORING MULCHER	24
7.2 REMOVING FROM STORAGE	24
<b>8. WARRANTY</b>	<b>25</b>

# **1. INTRODUCTION**

## **1.1 OVERVIEW**

Congratulations on your choice of a Skid Pro Brush Mulcher to complement your mulching operation. This equipment has been designed and manufactured to meet the needs of a discriminating buyer for efficient mulching of brush.

The rotor is hydraulic powered by the hydraulic system on your skid steer.

Replaceable bearings are provided at major pivot points for extended service life.

Safe, efficient and trouble free operation of your brush mulcher requires that you and anyone else who will be operating or maintaining the brush mulcher, read and understand the Safety, Operation, Maintenance and Troubleshooting information contained within the Operator's Manual.

This manual covers the Skid Pro Brush Mulcher. Use the Table of Contents as a guide to locate required information.

Keep this manual handy for frequent reference and to pass on to new operators or owners. Call your Skid Pro dealer, distributor or the factory if you need assistance, information or additional copies of the manuals.

When this machine is worn out and no longer in use, it should be returned to the retailer or other party for recycling.

**OPERATOR ORIENTATION** - The directions left, right, front and rear, as mentioned throughout this manual, are as seen from the skid steer driver's seat and facing in the direction of travel.

## **1.2 INTENDED USE AND FORESEEABLE MISUSE**

The brush mulcher is designed to be used by experienced operators, trained in the safe operation of a skid steer and trained in the hazards related to using the brush mulcher and the safe use of the mulcher for the intended purpose. Operators will require personal protective equipment to reduce the risk from some hazards that cannot be completely eliminated or controlled by the design of the tool.

Care is required to ensure that the brush mulcher tool will not come across metallic objects, stones or other materials.

Brush mulcher tools are not designed for use in hazardous atmospheres where there is a risk of fire or explosion due to flammable gases or vapors. Use in hazardous, explosive atmospheres is prohibited.

Serious injury or death of the operator or bystanders may be caused if the tool is misused. Misuse may also cause damage to the machine carrying the implement.

## 2. SAFETY

### 2.1 SAFETY ALERT SYMBOL AND SAFETY WORDS

You must read, understand and follow the instructions given by the operating unit manufacturers, as well as the instructions in this manual.

The safety information in this manual is denoted by the safety alert symbol:



This symbol means ATTENTION! BECOME ALERT! YOUR SAFETY IS INVOLVED!

The level of risk is indicated by the following signal words:



#### **DANGER**

**DANGER** - Indicates a hazardous situation, which, if not avoided, **WILL** result in death or serious injury.



#### **WARNING**

**WARNING** - Indicates a hazardous situation, which, if not avoided, could result in death or serious injury.



#### **CAUTION**

**CAUTION** - Indicates a hazardous situation, which, if not avoided, could result in minor or moderate injury.

#### **NOTICE**

*NOTICE* - Indicates a situation that could result in damage to the equipment or other property.

## 2.2 OPERATIONAL HAZARDS



#### **WARNING**

**Prevent serious injury or death.**

**Read and understand this manual before operating brush mulcher.**

**Always stop engine and remove key before leaving operators seat.**

**Never allow anyone near the brush mulcher during operation.**

**Travel at a safe speed.**



#### **WARNING**

**Prevent serious injury or death from moving parts.**

**Moving parts can crush and dismember.**

**Do not operate without guards and shields in place.**

**Disconnect and lock out power source before adjusting or servicing.**



#### **WARNING**

**Use brush mulcher only for the designed applications.**

**Any other use may result in personal injury, damage to equipment and may void the warranty.**



#### **WARNING**

**Prevent serious injury or death.**

**Verify brush mulcher is attached to skid steer before operation or transport.**



## **WARNING**

**Protect from flying debris.**

**Wear proper safety glasses, goggles, or a face shield to protect from flying debris.**

Carefully read all safety messages in this manual and on equipment safety signs. Keep safety signs in good condition and replace missing or damaged safety signs.

New equipment components and repair parts must include the current safety decal.

Learn how to properly operate equipment. NEVER operate or work around this equipment without proper instruction, while fatigued or under the influence of alcohol, prescription or non-prescription medication or if feeling ill.

Keep your equipment in proper working condition. Know the regulations and laws that apply to you and your industry. This manual is not to replace any regulations or laws. Additional information may be found at: [www.asae.org](http://www.asae.org) or [www.osha.gov](http://www.osha.gov). If you do not understand any part of this manual, contact Skid Pro at 866-820-5603.

### **2.2.1 PREPARE FOR EMERGENCIES**

- Be prepared in case of emergencies.
- Keep a fire extinguisher and first aid kit close to the machine.
- Keep emergency phone numbers close to your phone.
- Know your address so emergency services can locate you if an emergency arises.

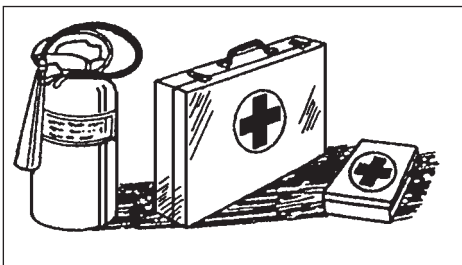

### **2.2.2 REPLACE SAFETY SIGNS**

- Replace missing or damaged safety signs.
- Safety signs are identified in Section 3 of this manual.
- Replacement safety signs are available from your Skid Pro dealer.

### **2.2.3 DO NOT ALLOW RIDERS**

- NEVER lift or carry anyone with brush mulcher.
- NEVER use brush mulcher as a work platform.
- NEVER allow passengers on brush mulcher.

### **2.2.4 LOWER OPERATING SPEED**

- Lower operating speed while loading, unloading or performing heavy operations.
- Keep load low and move at slow speeds on rough or uneven terrain.

### **2.2.5 AVOID ROLLOVER**

The equipment may rollover, resulting in death or serious injury. To help prevent rollover:

- Travel at a slow speed.
- Avoid sharp turns & sudden movement on slopes.
- Carry loads close to the ground.
- Avoid holes, ditches and other obstructions which may cause equipment to rollover.
- Balance load so weight is evenly distributed and load is stable.
- Use caution when operating on slopes and do not operate on excessively steep slopes.
- Do not exceed load capacity of equipment.

## **2.2.6 AVOID POWERLINES & UNDERGROUND UTILITIES**



### **DANGER**

**Prevent electrocution.**

**Death or serious injury can result if equipment comes near or contacts power lines.**

**Electrocution can occur without direct contact.**

DO NOT leave the operator's seat if any part of the equipment contacts electric lines or cables.

## **2.2.7 DETACH BRUSH MULCHER SAFELY**

Detach brush mulcher on a firm and level surface. Brush mulcher may fall over if detached on sloping or soft surface. Be sure people, livestock and pets are clear of machinery.

Relieve hydraulic pressure before disconnecting hydraulic hoses. See your skid steer Operator's Manual.

## **2.2.8 RAISED ATTACHMENT**



### **WARNING**

**Crushing hazard.**

**Raised, unsupported brush mulcher can fall, resulting in death or serious injury.**

**Never enter the area under a raised brush mulcher.**

A raised brush mulcher can lower unexpectedly, resulting in death or serious injury.

NEVER enter area under a raised brush mulcher. Lower brush mulcher to ground, engage parking brake, shut off engine and remove key before servicing.

## **2.2.9 AVOID LOUD NOISE**



### **WARNING**

**Prolonged exposure to loud noise can cause impairment or loss of hearing.**

**Wear a suitable hearing protective device such as earmuffs or earplugs to protect against objectionable or uncomfortable loud noises.**

## **2.2.10 HAZARDS FROM MODIFYING EQUIPMENT**

Do not make any alterations to your brush mulcher. Altering the equipment may cause unsafe conditions and may void the manufacturer's warranty.

## **2.2.11 AVOID WOOD DUST INHALATION**



### **WARNING**

**Wear an approved respirator (N95 Type as a minimum).**

**Follow local, state and federal regulations.**

The health effects from exposure to wood dust are due to chemicals in the wood or chemical substances in the wood created by bacteria, fungi, or molds.

## **2.2.12 AVOID HIGH PRESSURE FLUIDS**



### **WARNING**

**Pressurized fluids can penetrate the skin.**

**Hydraulic hoses can fail from age, damage and exposure.**

**Use body and face protection while searching for leaks. A tiny, almost invisible leak can penetrate the skin, thereby requiring immediate medical attention.**

**Use wood or cardboard to detect hydraulic leaks, never use your hands.**

Escaping fluid under pressure can penetrate the skin causing serious injury.

Prevent the hazard by relieving pressure (See skid steer Operator's Manual.) before connecting or disconnecting hydraulic lines. Verify all connections are tight before applying pressure.

Search for leaks with a piece of cardboard or wood.

Protect hands and body from high pressure fluids. If an accident occurs, see a doctor immediately. Any fluid injected into the skin must be surgically removed within a few hours or serious infection may result.

## 2.3 MAINTENANCE HAZARDS

Before servicing, park machine on a firm and level surface, set parking brake, chock wheels, and place a “Do Not Operate” tag on control panel. Read and understand this manual. If you do not understand any part of the manual, contact Skid Pro at 866-820-5603.

Always wear face and/or eye protection, safety shoes, and other protective equipment appropriate for the job.

Do not make unauthorized modifications. Contact Skid Pro at 866-820-5603 before you weld, cut/drill holes, or make any other modifications.

Always use Skid Pro replacement parts.



### WARNING

**Moving parts can crush and cut.**

**Keep clear of moving components.**

**Follow lockout procedure before servicing.**



### WARNING

**Entanglement hazard.**

**Keep clear of moving components.**

**Wear proper protective equipment appropriate for the job.**



### WARNING

**Crushing hazard.**

**Before performing inspections, service or maintenance:**

**Park machine on firm, level surface.**

**Engage parking brake.**

**Turn engine off and remove key.**

**Place “Do Not Operate” tag on control panel.**



### WARNING

**Burn hazard.**

**Hot and high pressure hydraulic oil.**

**Allow oil to cool before servicing.**



This page intentionally left blank.

## 2.4 SAFETY SIGNS

Dashed line indicates item hidden from view unless cover is removed.

NS - Non-Slip Pad

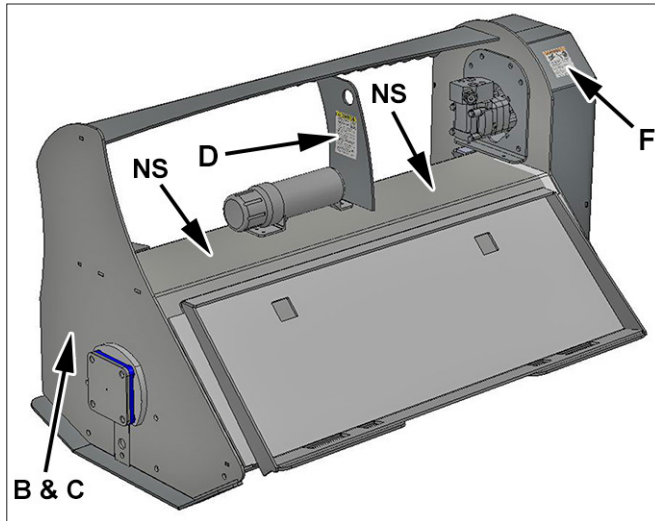

A. MTB-178 Safety Sign

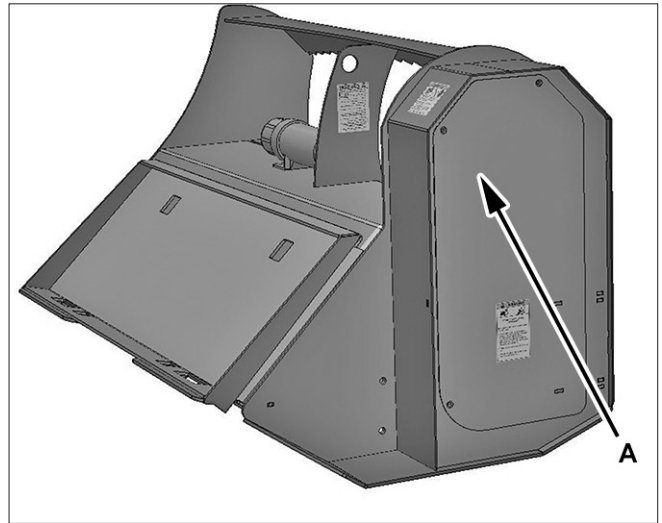
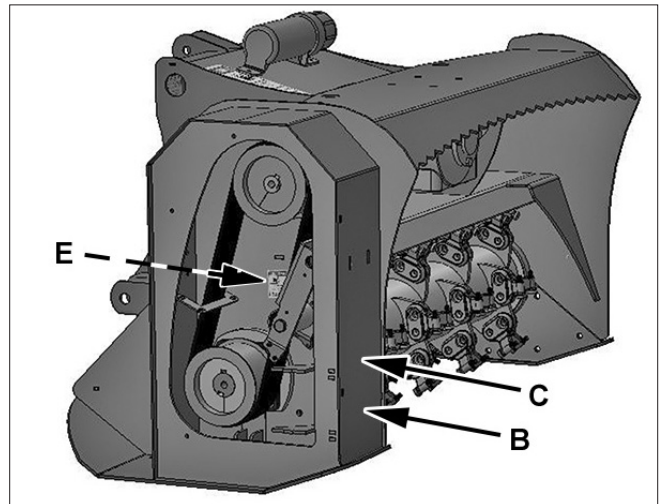
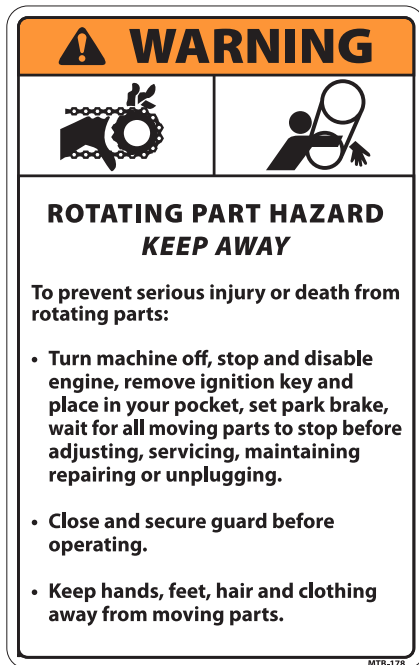

B. MTB-176 Safety Sign



C. MTB-177 Safety Sign



D. MTB-175 Safety Sign

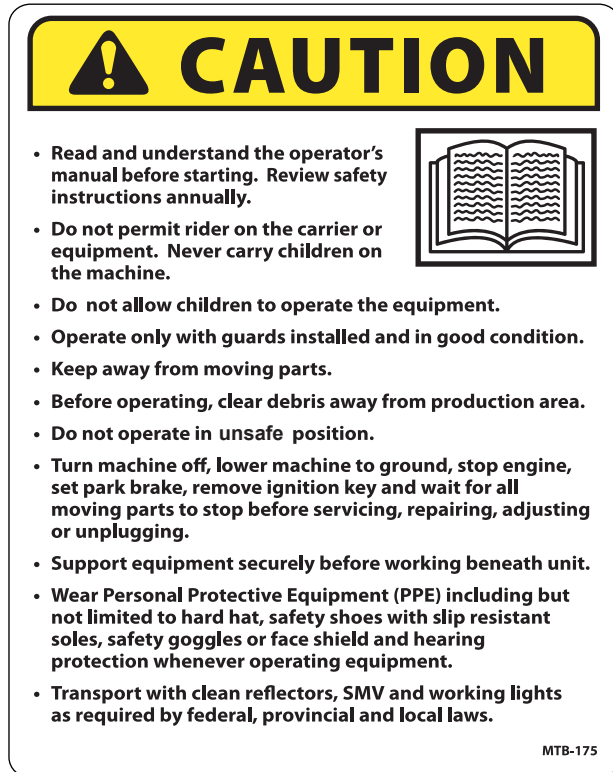

E. MTB-185 Safety Sign



F. MTB-182 Safety Sign



## 3. INITIAL SETUP

### 3.1 HYDRAULICS



#### WARNING

**Pressurized fluids can penetrate the skin.**

**Disconnect and lock out power source before disconnecting and/or connecting hydraulic hoses.**

The mulcher is equipped with short hoses that are connected to the hydraulic motor. You must connect your skid steer hoses to these hoses.

Skid steer hoses must be the same size as the mulcher hoses. Using smaller diameter hoses will decrease hydraulic flow.

The mulcher will have pressure and return connections. Pressure hose on mulcher will have a red tie band (A) on it.

The hose end size is 1/2 in. female JIC for the pressure and return hoses.

Connect skid steer hoses to the mulcher hoses. Be sure mulcher pressure hose with red tie band (A) is connect to skid steer pressure hose.

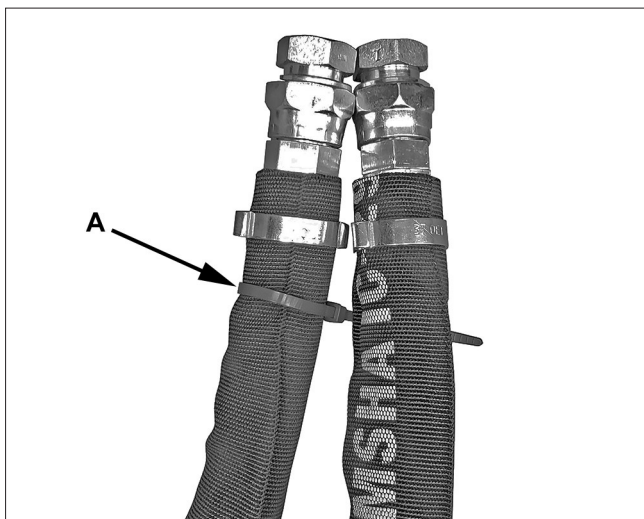

## 4. OPERATION

### 4.1 PREPARATION FOR USE



#### WARNING

**Wear an approved respirator (N95 Type as a minimum).**

**Follow local, state and federal regulations.**

**The health effects from exposure to wood dust are due to chemicals in the wood or chemical substances in the wood created by bacteria, fungi, or molds.**

Although the brush mulcher has been carefully inspected and checked prior to shipment from manufacturer, it is recommended that the unit be thoroughly inspected.

Check all bolts for tightness and remove all shipping tags, bags, skids, and blocking.  
Review and understand this manual and operating unit manual.

Remove any masking materials affixed during painting. Inspect the mulcher and any accessory equipment to verify that nameplates and all safety warning, caution signs and decals provided with the equipment are in place and clearly visible.

Visually inspect the unit before each start up. Check for loose or missing parts and any damage that may have occurred during moving or shipping. Review all skid steer pre-start instructions, and be sure that all recommended steps and procedures have been followed.

Note: Always keep the weight of the machine in mind. Never position body in line of impact.

### 4.2 PRE-OPERATION CHECK LIST

Check-mark	Check these items:	Frequency
	Verify that mulcher is properly attached to skid steer.	Each operation.
	Verify that hydraulic hoses are connected to skid steer hydraulic couplers.	Each operation.
	Check for entangled material on rotor.	Each operation.
	Verify all guards, doors and covers are installed and secured.	Each operation.
	Verify cutting teeth on the rotor are tight.	Every 4 hours.
	Check belt chamber.	Every 4 hours.

### 4.3 MACHINE COMPONENTS

Dashed line indicates item hidden from view unless cover is removed.

- A. Operators Manual Storage Tube
- B. Quick Attach
- C. Safety Push Bar
- D. Cutting Teeth
- E. Rotor

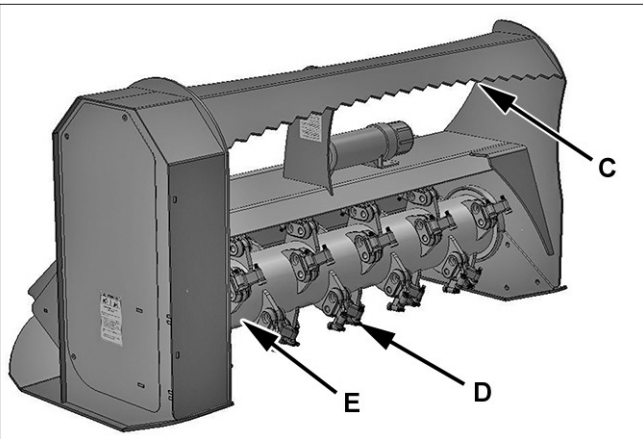
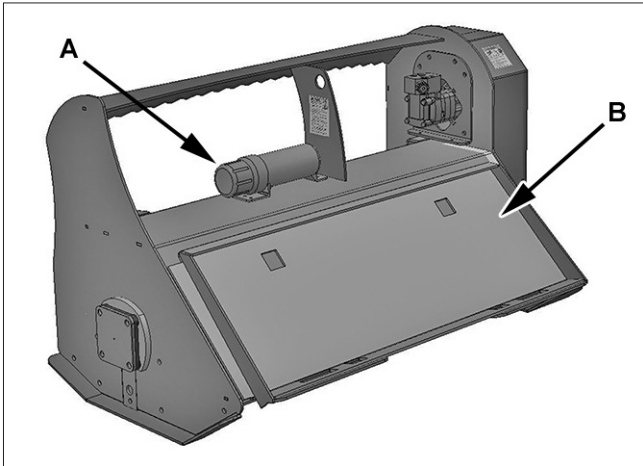

### 4.4 ATTACH TO SKID STEER



#### WARNING

**To prevent injury or machine damage put transmission in “Park”.**

**Never position yourself between skid steer and brush mulcher.**

**Only experienced and properly trained operator's should operate the skid steer and brush mulcher.**

1. Read and follow all safety instructions.
2. Attach mulcher to skid steer. See skid steer Operator's Manual.
3. Verify pins are secure in the correct position.
4. Connect hydraulic hoses. Verify hydraulic hoses are clear of pinch areas and moving parts.
5. Move to a clear open area to test functions.

## **4.5 DETACH FROM SKID STEER**



### **WARNING**

**Prevent serious injury or death caused by unexpected movement:**

- 1. Park skid steer on a level surface.**
- 2. Engage skid steer park brake.**
- 3. Disconnect hydraulic drive.**
- 4. Shut off engine and remove key.**

1. Park skid steer on a level surface.
2. Lower mulcher to the ground.
3. Shut off engine and remove key.
4. Disconnect hydraulic hoses.
5. Detach mulcher from skid steer. See skid steer Operator's Manual.

## **4.6 TRANSPORTING**

1. Verify all reflectors and Slow Moving Vehicle (SMV) sign are visible.
2. Raise brush mulcher slightly off ground.
3. Verify hydraulics are disengaged.
4. Travel at a reasonable and safe speed.



### **WARNING**

**To prevent bodily injury from rotating cutting wheel, be sure to disengage hydraulics before transporting mulcher.**

## **4.7 CARBIDE TEETH BREAK-IN**

During the first few hours of use, avoid hitting stones as much as possible to allow the carbide teeth to wear slightly. This can be done by keeping the cutting wheel above ground level. Brand new carbide tips are razor sharp and can chip and shatter easily when they hit hard objects. Once the razor sharpness has worn away, the tips do not chip as easily. Observing these precautions will extend the life of the carbide teeth and reduce operating expenses.

The teeth bolts must be retighten every ten minutes for the first hour of use on a new mulcher.

## **4.8 FIRST TIME USER TIPS**

- First, operate all functions in a clear area with skid steer at idle speed to get a good feel for the controls before you actually move into any brush.
- Choose low density brush and move into it slowly, do not expect to get the first area done fast.
- Slow travel speed if pressure surges up close to max psi, doing this will greatly reduce rotor jams, and with practice, will almost eliminate jams.
- Run throttle only at half speed for first time users.
- Operate with mulcher slightly raised until you have a better feel how much the unit can take.
- The machine is equipped with a push bar to push brush or small trees over. This will allow the mulcher teeth to contact the lower portion of the brush and mulch it or cut it off. The rest of the plant will be mulched as the machine moves through the working area.
- For tall brush, you can use the push bar to push the brush over and cut it off close to ground. Each operator must experiment to find a technique that works for them in their application.
- Although it is best to mulch when it is dry, the machine works well in wet conditions. However, you must travel slower to do the same quality mulching. It will also be necessary to clean the machine more frequently to prevent caking and clogging of the rotor area.



### **WARNING**

**Always turn off the skid steer and disengage hydraulic drive before getting off the seat and approaching the cutting wheel.**



### **WARNING**

**Wear an approved respirator (N95 Type as a minimum).**

**Follow local, state and federal regulations.**

**The health effects from exposure to wood dust are due to chemicals in the wood or chemical substances in the wood created by bacteria, fungi, or molds.**



## 4.9 FIELD OPERATION

### WARNING

Prevent serious injury or death caused by unexpected movement:

1. Park skid steer on a level surface.
2. Engage skid steer park brake.
3. Disengage hydraulic drive.
4. Shut off engine and remove key.

### WARNING

Prevent serious injury or death.

Do not allow riders on skid steer.

### WARNING

Never operate brush mulcher when other people are in the vicinity.

Debris can be thrown several feet from cutting area.

Keep all shields in place.

### WARNING

Clean machine thoroughly before service or maintenance procedures.

The health effects from exposure to wood dust are due to chemicals in the wood or chemical substances in the wood created by bacteria, fungi, or molds.

1. Attach brush mulcher to skid steer. See Attach Brush Mulcher in this section.

### WARNING

Prevent serious injury or death.

Operating unit must be equipped with a forestry guard to protect the operator.

2. Lower mulcher so skid plates are on ground.
3. Set engine speed to low idle and engage mulcher.
4. Slowly increase engine speed to high idle. Verify mulcher is operating smoothly and start travel.
5. If mulcher stalls, stop movement, slightly raise mulcher and allow rotor to regain speed. Slow ground speed to prevent further stalling.

### WARNING

Moving parts can crush and cut.

Keep clear of moving components.

Lockout operating unit before clearing jams.

### WARNING

Never approach brush mulcher before cutting wheel has come to a complete stop.

## 4.10 CLEARING JAMS

If the rotor stalls, stop rotor motion and raise slightly and try again.

1. If still stalled, lower unit so teeth tips dig slightly into sod, a log or stump.
2. Reverse hydraulic flow to mulcher. Reversing the flow does not power the rotor in the reverse direction, it only opens the hydraulic lock on the rotor. The rotor will not be powered in the reverse direction.
3. Drag the rotor across sod, a log or stump in reverse direction to dislodge the jam.



### WARNING

**Always turn off the skid steer and disengage hydraulic drive before getting off the seat and approaching the cutting wheel.**

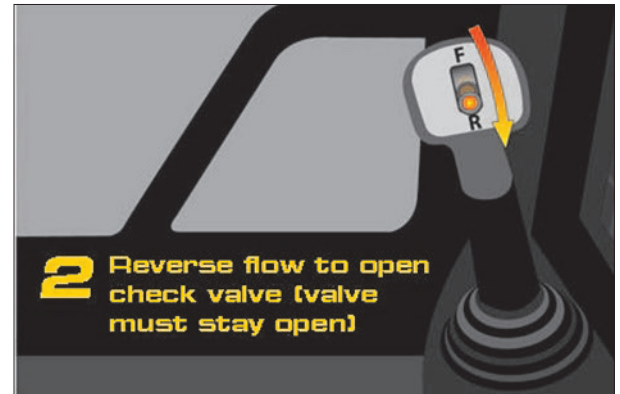

## 5. ROUTINE MAINTENANCE

### 5.1 MAINTENANCE

Maintenance Chart		
General Inspection	Inspect the unit for any buildup of contamination (dirt, stones, etc.).	Daily
Cutting Teeth	The teeth bolts must be retighten every ten minutes for the first hour of use on a new mulcher.	First hour of use.
Cutting Teeth	Check and rotate replace one at a time as necessary. With daily use expect to replace 4 to 6 teeth per day. See Replace Cutting Teeth in this section.	Every 4 hours.
Drive Belt	Check belt tension, alignment and inspect belt for wear or damage. Replace damaged or worn belt.	Daily.
Rotor Bearings	Check bearings for side-to-side and up/down movement. Replace bearings if movement is found.	Every week.
Rotor Bearings	Lubricate rotor bearings.	1 pump every 250 hours of use.

### 5.2 INSPECTIONS



#### WARNING

**Prevent serious injury or death caused by unexpected movement:**

1. Park skid steer on a level surface.
2. Engage skid steer park brake.
3. Disengage hydraulic drive.
4. Shut off engine and remove key.



#### WARNING

**Clean machine thoroughly before service or maintenance procedures.**

**The health effects from exposure to wood dust are due to chemicals in the wood or chemical substances in the wood created by bacteria, fungi, or molds.**

Inspect the unit for any buildup of contamination (dirt, stones, etc.).

Check cutting teeth every 4 hours of use. Keep cutting teeth in good condition. Unit will cut faster and remaining teeth will last longer if broken teeth are replaced.

### 5.3 CHECK BELT TENSION

1. Lower mulcher to ground.
2. Set parking brake, stop engine and remove key.



#### WARNING

**Moving parts can crush and cut.**

**Keep clear of moving components.**

**Follow lockout procedure before servicing.**

3. Open inspection cover (A).

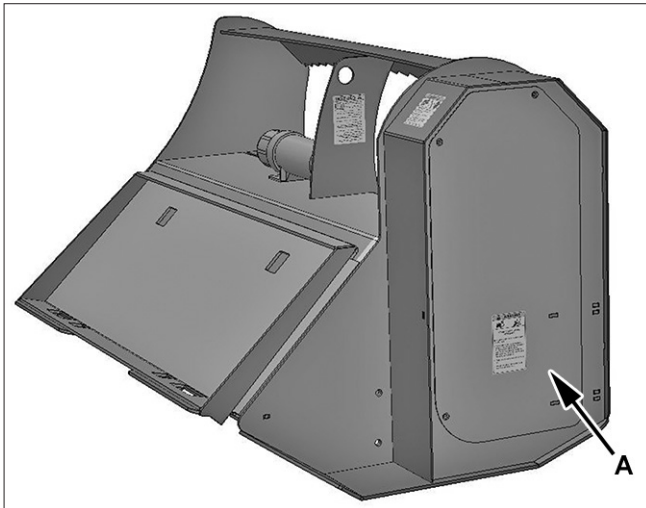

4. Inspect belt (B) for wear, damage, alignment and proper tension.
5. Loosen hydraulic motor mounting bracket and adjust tension bolts to set belt tension. Tighten motor mounting bracket.
6. Belt deflection (C) should be 0.5 in. (13 mm) at 3.0 lbs of force for a used belt or 4.25 lbs of force for a new belt.
7. Place a straight edge (D) on motor pulley and rotor pulley. Pulleys must be aligned or belt will wear quickly. Adjust pulleys if necessary.

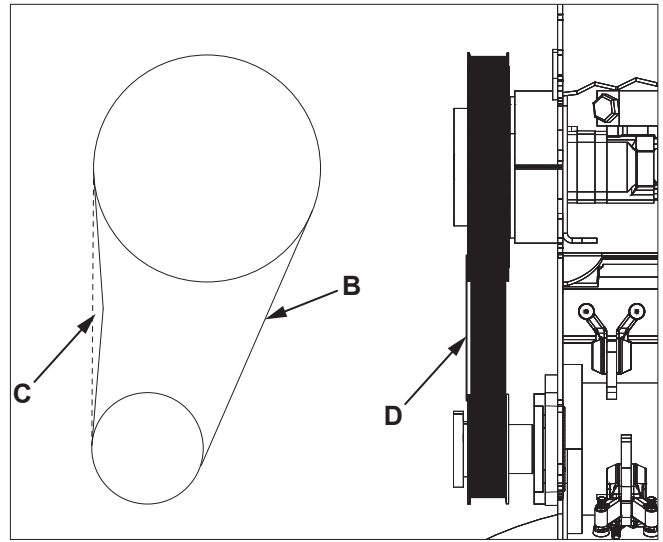

8. Close inspection cover (A). Do not operate mulcher with inspection cover (A) open or removed.

## 5.4 REPLACE BELT

1. Lower mulcher to ground.
2. Set parking brake, stop engine and remove key.



### WARNING

**Moving parts can crush and cut.**

**Keep clear of moving components.**

**Follow lockout procedure before servicing.**

3. Open inspection cover (A).



4. Loosen hydraulic motor mounting bracket.
5. Remove shaft pulley bolt (B) and washer (C).
6. Remove three hub bolts (D). Place hub bolts into threaded holes (E) in hub (F).
7. Evenly tighten bolts to push pulley (G) off of hub (F).
8. Remove hub (F), pulley (G) and belt (H). It may be necessary to lightly tap hub if hub stuck to shaft.
9. Install belt, pulley and hub onto shaft.
10. Install washer (C) and shaft bolt (B). Tighten bolt.
11. Align pulley holes with non threaded holes in hub (F) and install bolts (D).
12. Place a straight edge (I) on drive pulley and rotor pulley. Pulleys must be aligned or belt will wear quickly. Adjust pulley alignment as necessary and tighten bolts (D).

13. Belt deflection (J) should be 0.5 in. (13 mm) at 4.25 lbs of force.

14. Adjust tension and tighten motor mounting bracket.
15. Close inspection cover (A). Do not operate mulcher with cover (A) open or removed.

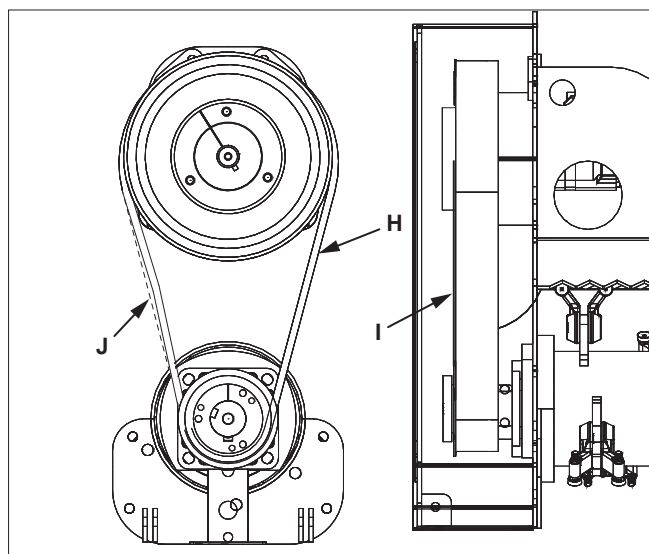
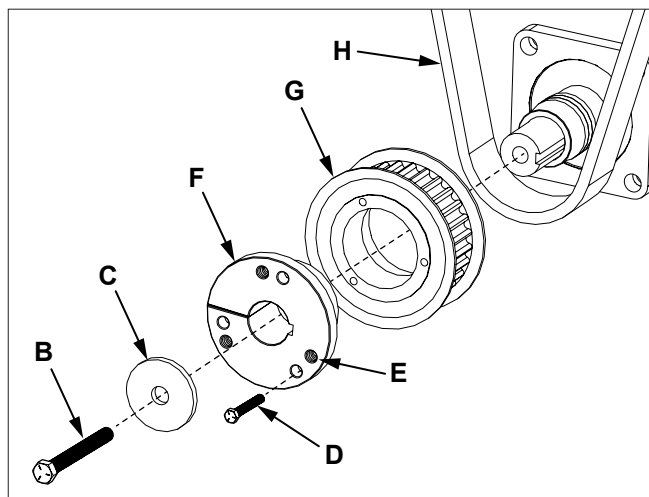

## 5.5 ROTATE CUTTING TEETH

Each tooth can be rotated up to two times before replacement is necessary.

1. Park skid steer and mulcher on a level surface.
2. Lower mulcher to the ground.
3. Shut off engine and remove key.
4. Inspect teeth for wear on top edge. Once top edge is worn, rotate tooth so a new edge is on top (cutting) edge.
5. Loosen  $\frac{3}{8}$  inch locknut and spacer (A) on tooth (B). Rotate tooth  $\frac{1}{3}$  turn. Flat shoulder on tooth will fit against shoulder (C) on tooth holder.
6. Tighten  $\frac{3}{8}$  inch locknut to 65 lb/ft (88 Nm) of torque.

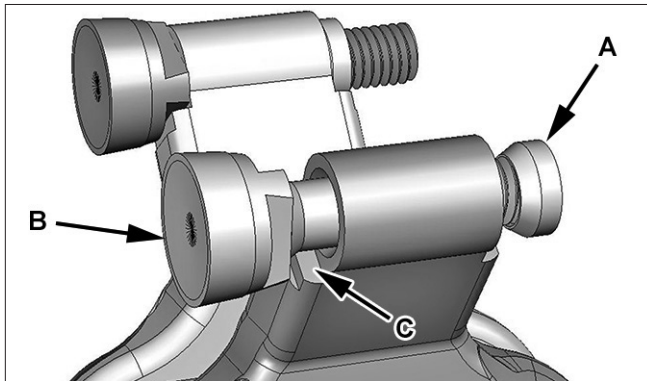
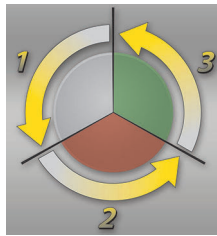

## 5.6 REPLACE CUTTING TEETH

1. Park skid steer and mulcher on a level surface.
2. Lower mulcher to the ground.
3. Shut off engine and remove key.
4. Inspect cutting teeth (B) for damage and wear. Replace individual teeth as needed.
5. Remove  $\frac{3}{8}$  inch locknut and spacer (A) on tooth (B). Install new tooth. Flat shoulder on tooth will fit against shoulder (C) on tooth holder.
6. Install tooth and spacer (A). Tighten  $\frac{3}{8}$  inch locknut to 65 lb/ft (88 Nm) of torque.

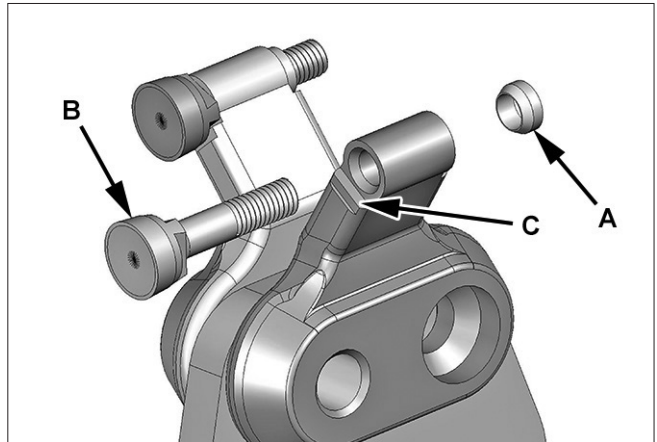

## **5.7 REPLACE TOOTH HOLDER**

1. Park skid steer and mulcher on a level surface.
2. Lower mulcher to the ground.
3. Shut off engine and remove key.
4. Inspect tooth holders (A) for damage and wear. Replace individual tooth holders as needed.
5. Remove tooth from tooth holder.
6. Remove mounting hardware on tooth holders (A). Install new tooth holder, install and tighten mounting hardware.
7. Install tooth into new tooth holder. Tighten  $\frac{3}{8}$  inch locknut to 65 lb/ft (88 Nm) of torque.

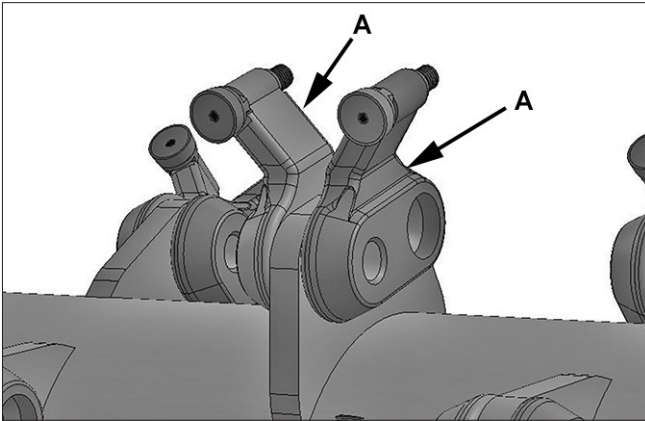



## **5.8 LUBRICATE ROTOR BEARINGS**

The bearings are factory lubricated with a general purpose grease which is suitable for most applications

The bearings should contain as much grease as speed will permit. A full bearing with consequent slight leakage through the seal is the best protection against contaminant entry.

Extreme situations may require a change in lubricating periods as dictated by experience.

Generally, a lower quantity of grease at frequent intervals is more effective than a greater quantity at extended lubrication intervals.

Typical lubrication quantity is 1 pump from a standard grease gun every 250 hours.

In the higher speed ranges too much grease will cause overheating. The amount of grease that the bearing will take for a particular high speed application can be determined only by experience. If excess grease in the bearing caused overheating, it will be necessary to remove grease fitting to permit excess grease to escape.



## 6. TROUBLESHOOTING

PROBLEM	CHECK	SOLUTION
Rotor does not spin.	Rotor jammed.	Remove material from rotor. See Clearing Jams.
	Low oil level.	Check oil level in skid steer. Add if necessary.
	Low oil flow.	Check flow control on skid steer. See your dealer.
Rotor rotates slow or sluggish.	Low oil.	Check oil level in skid steer. Add if necessary.
	Oil filter plugged.	Replace skid steer oil filter.
	Relief valve not set properly.	Set relief pressure 2500 - 3500 psi.
	Low oil flow.	Check flow control on skid steer. See your dealer.
	Drive belt loose.	Tighten drive belt.
Excessive vibration.	Cutting teeth worn or missing.	Replace worn, broken or missing teeth.
	Debris lodged in rotor.	Remove debris.

## **7. STORAGE**

---

### **7.1 STORING MULCHER**

1. Store mulcher in a dry place.
2. Clean mulcher thoroughly. Dirt and wood chips will draw moisture and cause rust.
3. Check condition of cutting teeth. Replace as necessary. (See Service and Maintenance section.)
4. Check for loose or missing hardware.
5. Paint parts as necessary.

### **7.2 REMOVING FROM STORAGE**

1. Review Operator's manual and check adjustments.
2. If parts have been replaced, verify they run properly.

## 8. WARRANTY

---

Skid Pro warrants products purchased from Skid Pro to the Original Retail Purchaser to be free from defects in material and workmanship for a period of twelve (12) months from the warranty start date.

Skid Pro warranty service includes parts and labor costs required to repair or replace products purchased from Skid Pro at the selling dealer's business location. Skid Pro makes no representations or warranties of any kind, expressed or implied (including the implied warranties of merchantability and fitness for particular purpose), except as expressly stated in this warranty statement.

Skid Pro warranty service does not include:

1. Transportation to selling dealer's business location or, at the option of the original retail purchaser, the cost of a service call.
2. Used equipment.
3. Components covered by their own non-Skid Pro warranties
4. Normal maintenance service and expendable wear out items.
5. Repairs or adjustments caused by improper use; failure to follow recommended maintenance procedures; accidents or other casualty.
6. Liability for incidental or consequential damages of any type, including but not limited to lost profits of expenses of acquiring replacement equipment.

No agent, employee or representative of Skid Pro has authority to bind Skid Pro to any warranty except as specifically set forth herein. Any of these limitations excluded by local law shall be deemed deleted from this warranty; all other terms will continue to apply.

**For warranty service contact:**

**Skid Pro, Inc.**

Toll Free: 877.378.4642

E-mail: [sales@skidpro.com](mailto:sales@skidpro.com)



**Skid Pro Attachments**  
**PO Box 982**  
**Alexandria, MN 56308**  
**[www.skidpro.com](http://www.skidpro.com)**

**October 2021**